

ALL DIMENSIONS IN INCHES

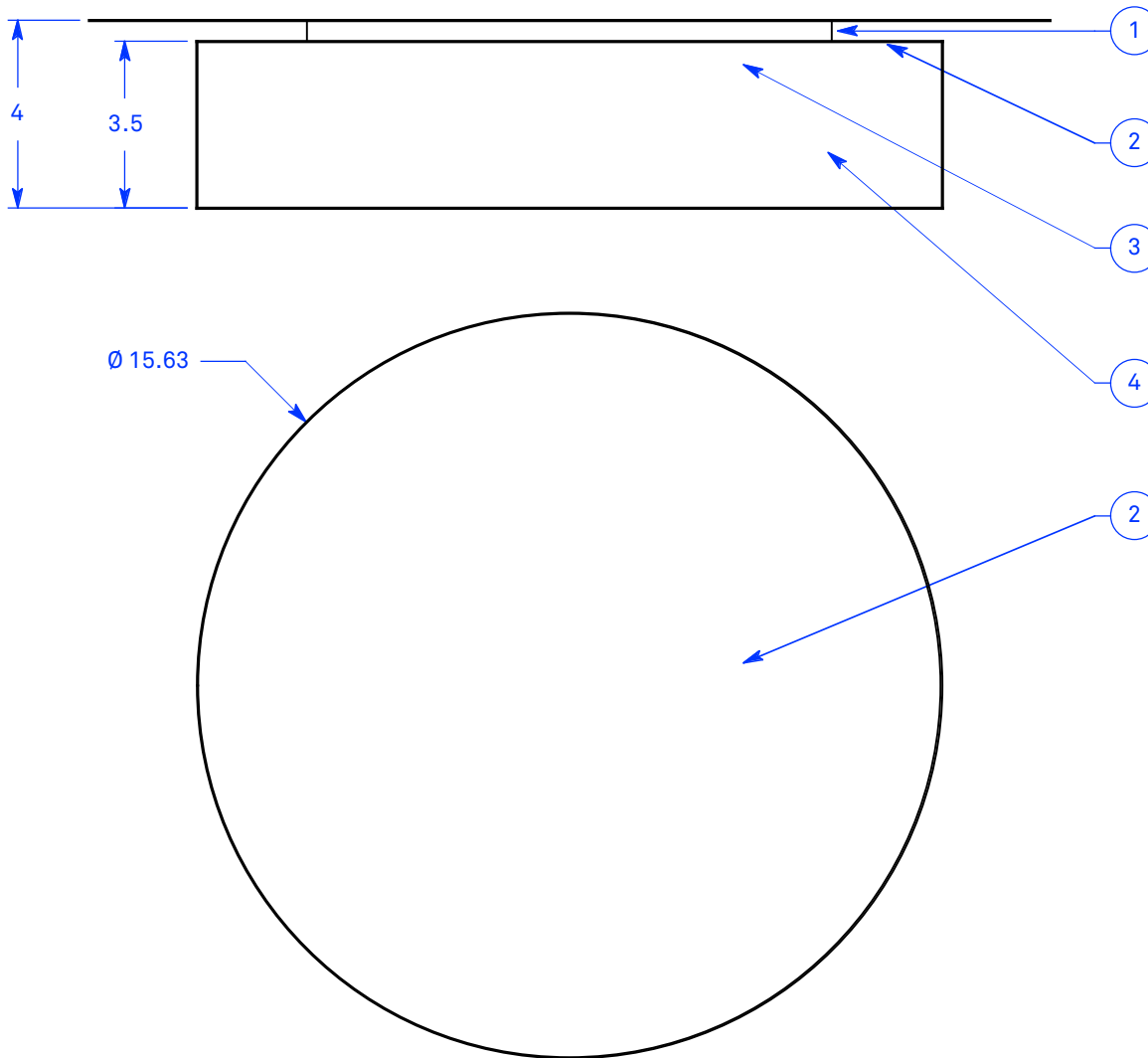

NOTES:

1. Ø 11" white canopy with white powdercoated Ø 13" steel faceplate for magnetic shade attachment
2. Opal white high-impact copolymer top and bottom diffusion disks
3. 3x955 lumen 2700K 80 CRI LED module (90 CRI available upon request)
4. Carnegie Xorel fabric backed with opal white high-impact copolymer

Type:

Quantity:

Approval signature:

Name:

Firm:

Date:

Crown Hill
Model SN04
30 Watt LED
TRIAC/ELV 10% Dimming
Universal voltage

Xorel fabric selection:

1.24.19

RESOLUTE

4617 Colorado Ave. S, Unit A
Seattle, WA 98134
T 206.343.9323
F 888.346.8079
info@resoluteusa.com

