

# ASSEMBLY INSTRUCTIONS

## S17/22 PENDANT

**DANGER - RISK OF SHOCK - DISCONNECT POWER BEFORE INSTALLATION**

1. Determine drop length. Measure, trim and strip electrical cord to the appropriate length.
2. Attach box adapter to junction box.
3. Feed cord through cord bushing in the canopy.
4. Make electrical connections per wiring diagram.
5. Affix canopy to the junction box/box adapter assembly with the two mounting screws provided.
6. Feed aircraft cable through cable grip until desired drop length has been achieved.
7. Push any excess electrical wire into the canopy and trim excess aircraft cable.

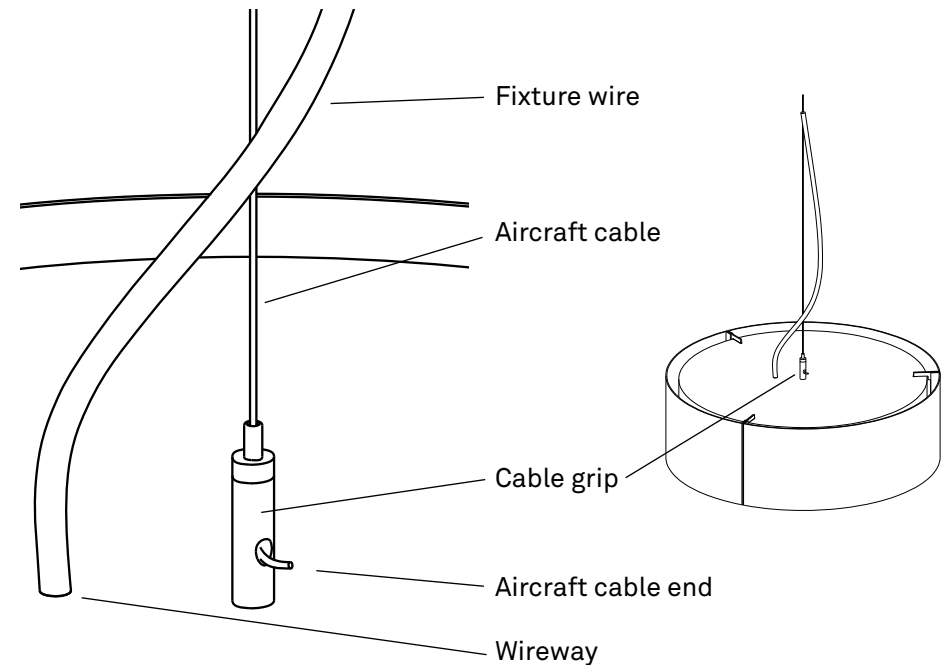
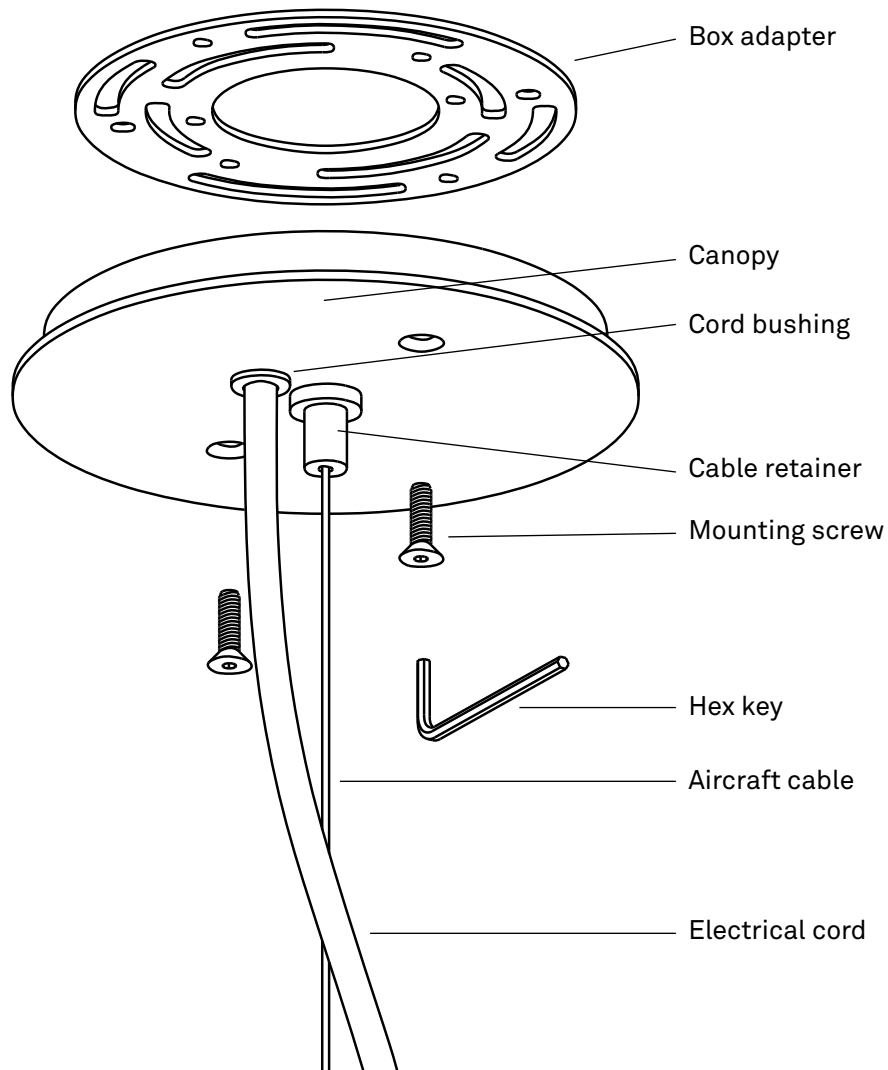

**RESOLUTE**

RESOLUTE is a registered trademark of  
MANIFESTO Corporation, Seattle WA  
[www.resoluteonline.com](http://www.resoluteonline.com) [info@resoluteusa.com](mailto:info@resoluteusa.com)



# ASSEMBLY INSTRUCTIONS

## SMITH 17/22 - DIFFUSER ASSEMBLY

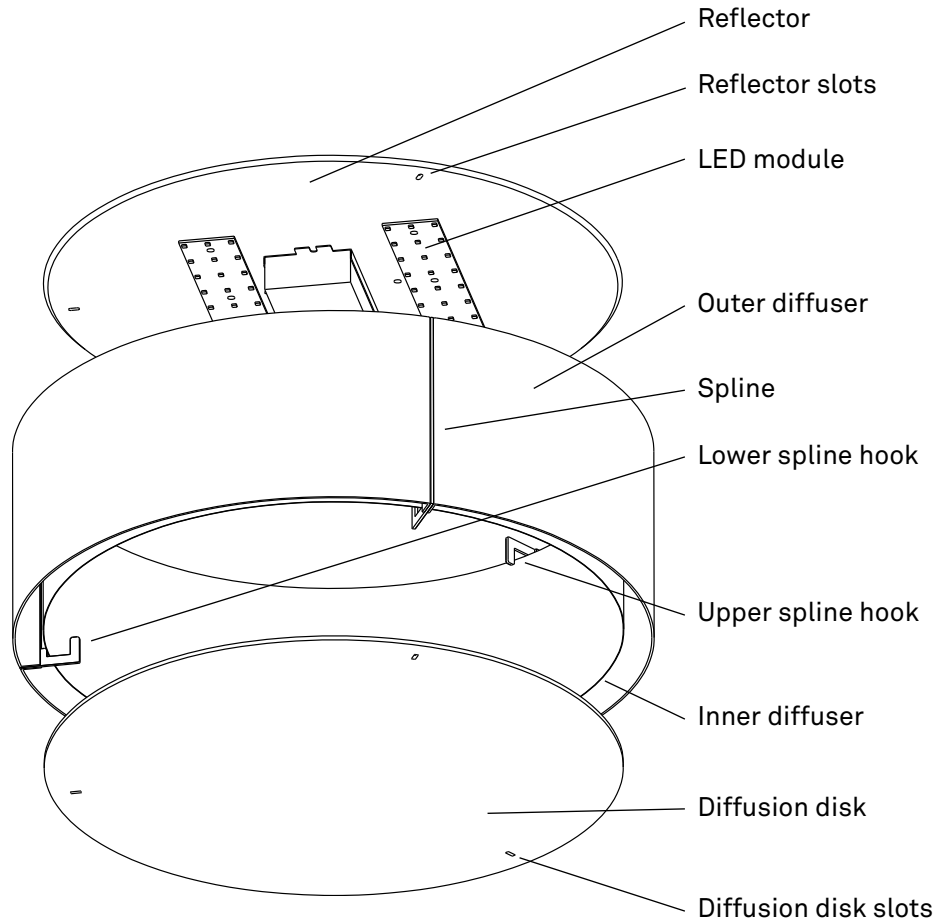

### Installing shade assembly

1. Raise assembled shade up slightly above the reflector, making sure that all the upper spline hooks are above the reflector.
2. Insert all three upper spline hooks into slots in the reflector.

### Installing bottom diffusion disk

1. Raise the diffusion disk up into the shade at an angle up and over two of the three lower spline hooks.
2. Continue to raise the diffusion disk inside shade so as to clear the third lower spline hook.
3. Lay diffusion disk flat and insert hooks into slots in diffusion disk.

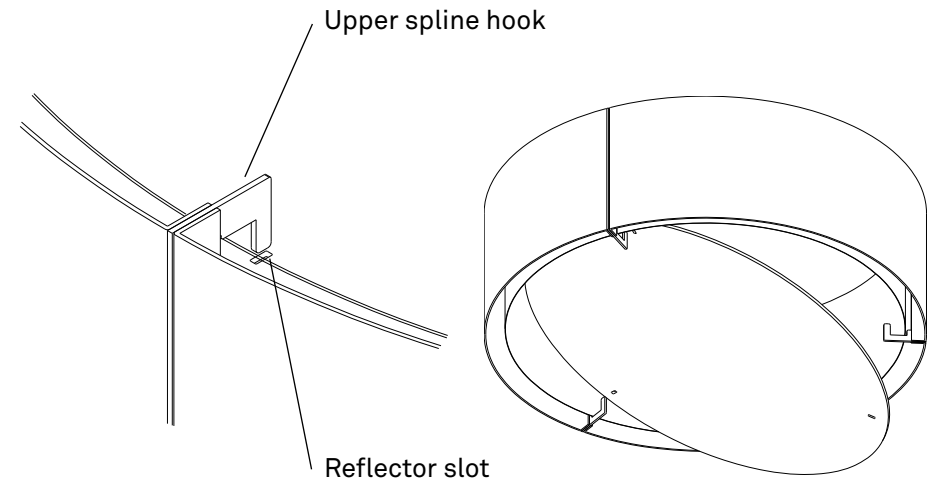

**RESOLUTE**

RESOLUTE is a registered trademark of  
MANIFESTO Corporation, Seattle WA  
[www.resoluteonline.com](http://www.resoluteonline.com) [info@resoluteusa.com](mailto:info@resoluteusa.com)



# TRIAC/ELV 10% Dimming

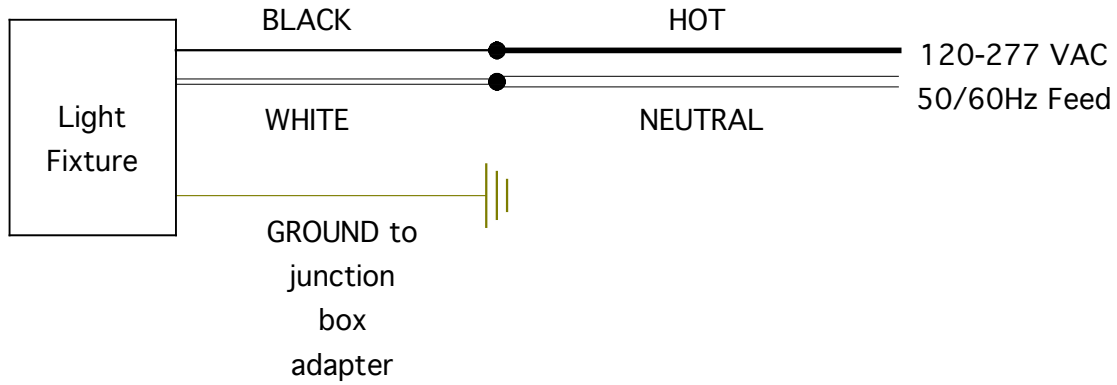

# 0-10V Dimming

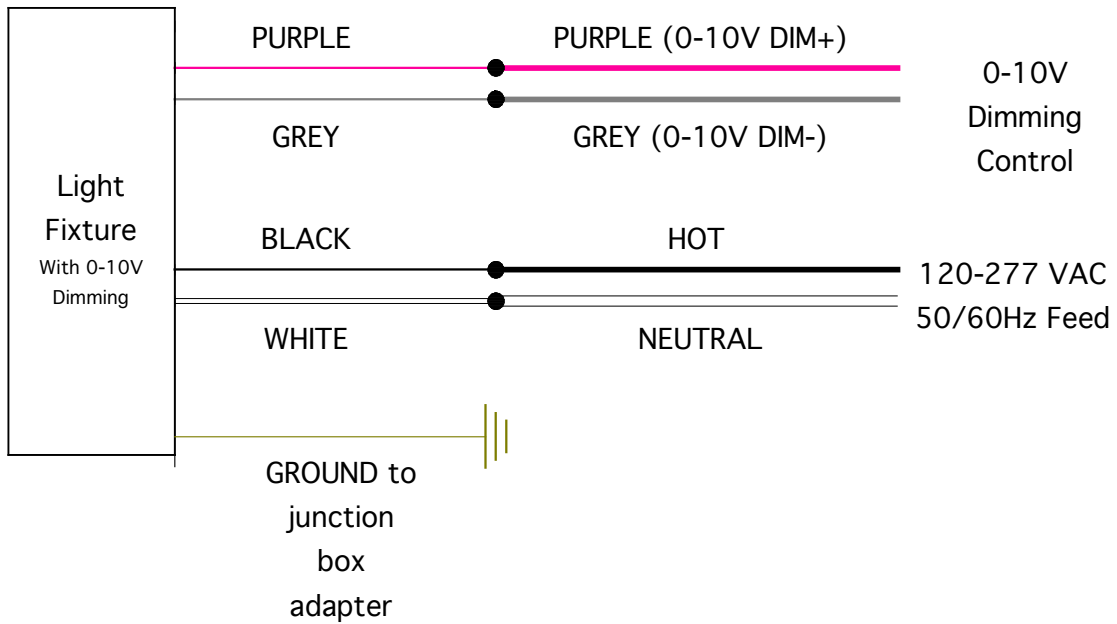

# Wiring for EcoSystem™ Digital Control\*\*

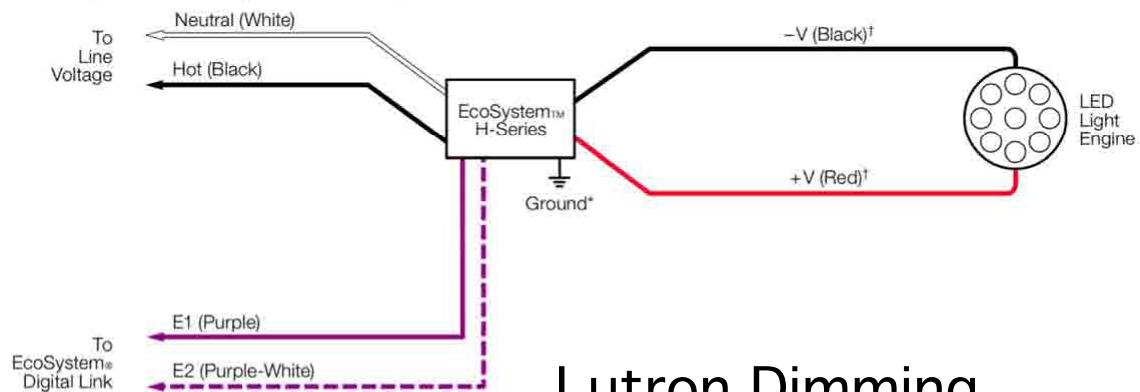

# Lutron Dimming

For Lutron 2-Wire Forward-Phase go to:

<http://www.lutron.com/TechnicalDocumentLibrary/041549.pdf>