

ASSEMBLY INSTRUCTIONS

SMITH 17/22 CEILING

DANGER - RISK OF SHOCK - DISCONNECT POWER BEFORE INSTALLATION

1. Attach box strap to the junction box.
2. Make electrical connections per wiring diagram.
3. Avoid contact with the LED modules when installing the fixture.
4. Affix fixture to the box strap/junction box assembly with the two mounting screws provided. Use the tooth washer to ensure proper grounding of the fixture.
5. Make sure the canopy is snug up against the ceiling.

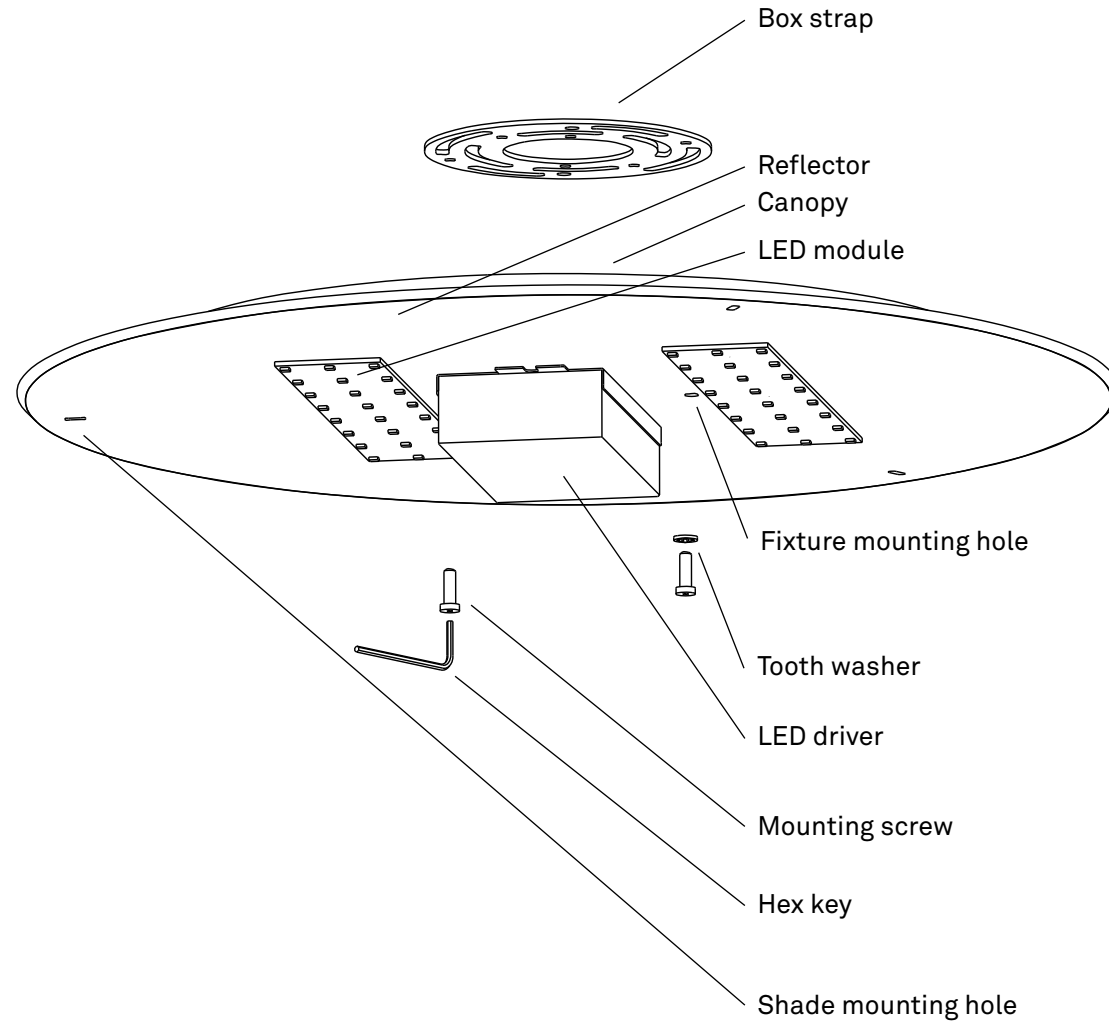

RESOLUTE

RESOLUTE is a registered trademark of
MANIFESTO Corporation, Seattle WA
www.resoluteonline.com info@resoluteusa.com



ASSEMBLY INSTRUCTIONS

SMITH 17/22 - DIFFUSER ASSEMBLY

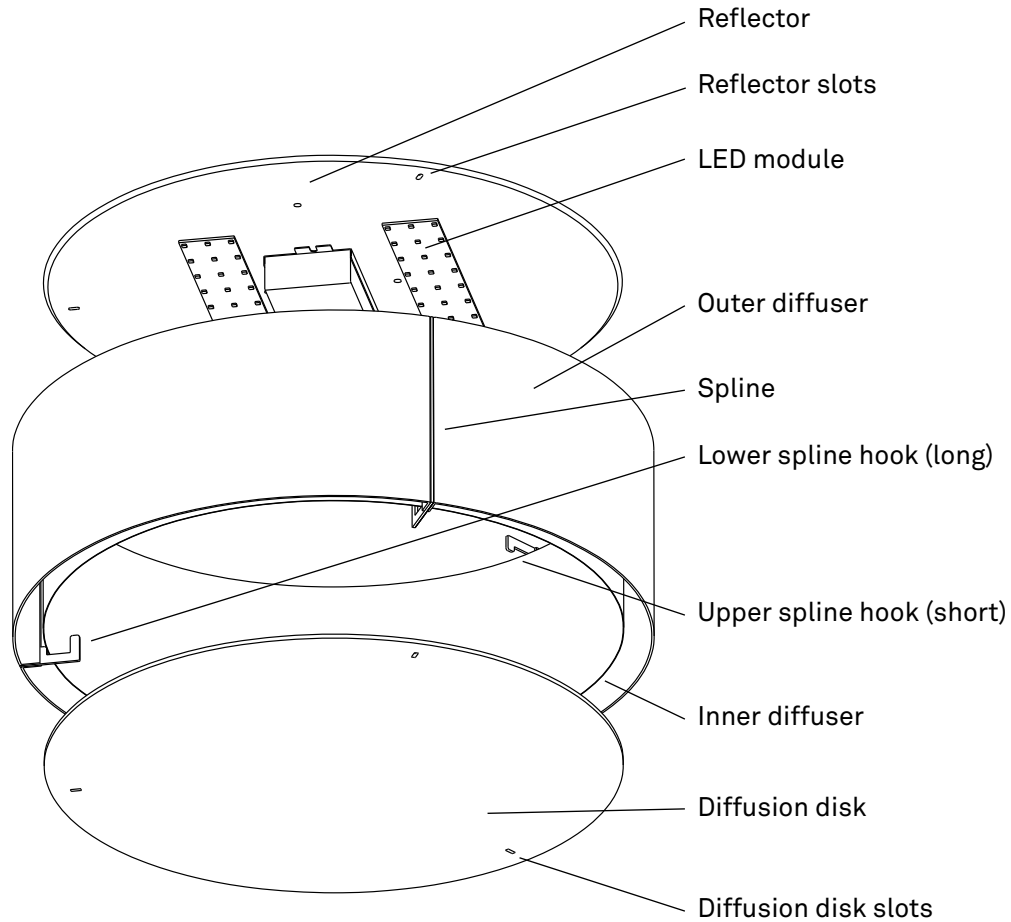

Installing shade assembly

1. Raise assembled shade up slightly above the reflector, making sure that all the upper spline hooks are above the reflector.
2. Insert all three upper spline hooks into slots in the reflector.

Installing bottom diffusion disk

1. Raise the diffusion disk up into the shade at an angle up and over two of the three lower spline hooks.
2. Continue to raise the diffusion disk inside shade so as to clear the third lower spline hook.
3. Lay diffusion disk flat and insert hooks into slots in diffusion disk.

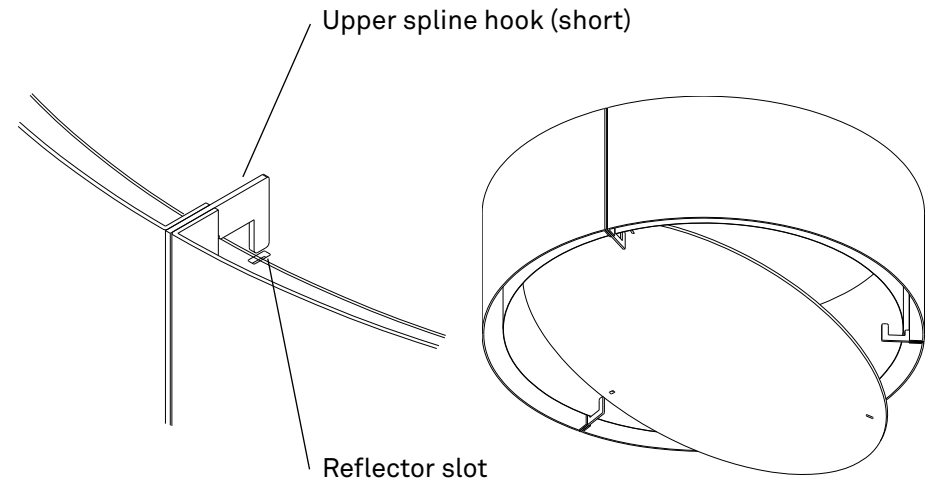

RESOLUTE

RESOLUTE is a registered trademark of
MANIFESTO Corporation, Seattle WA
www.resoluteonline.com info@resoluteusa.com



TRIAC/ELV 10% Dimming

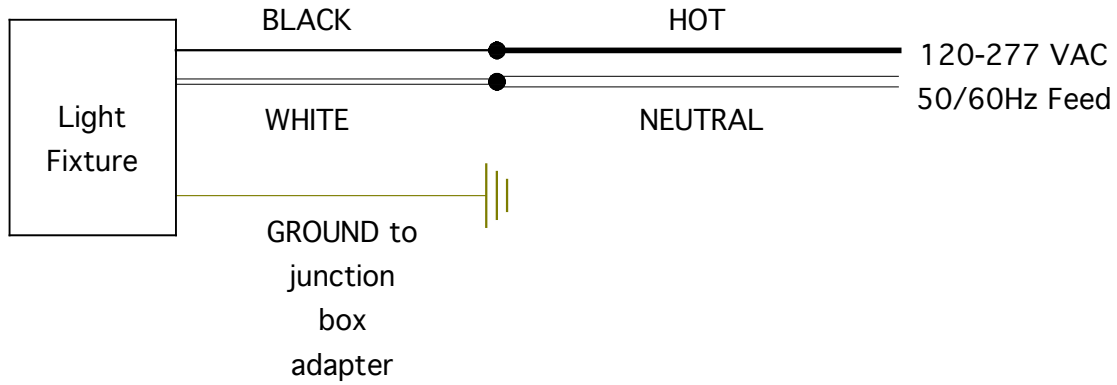

0-10V Dimming

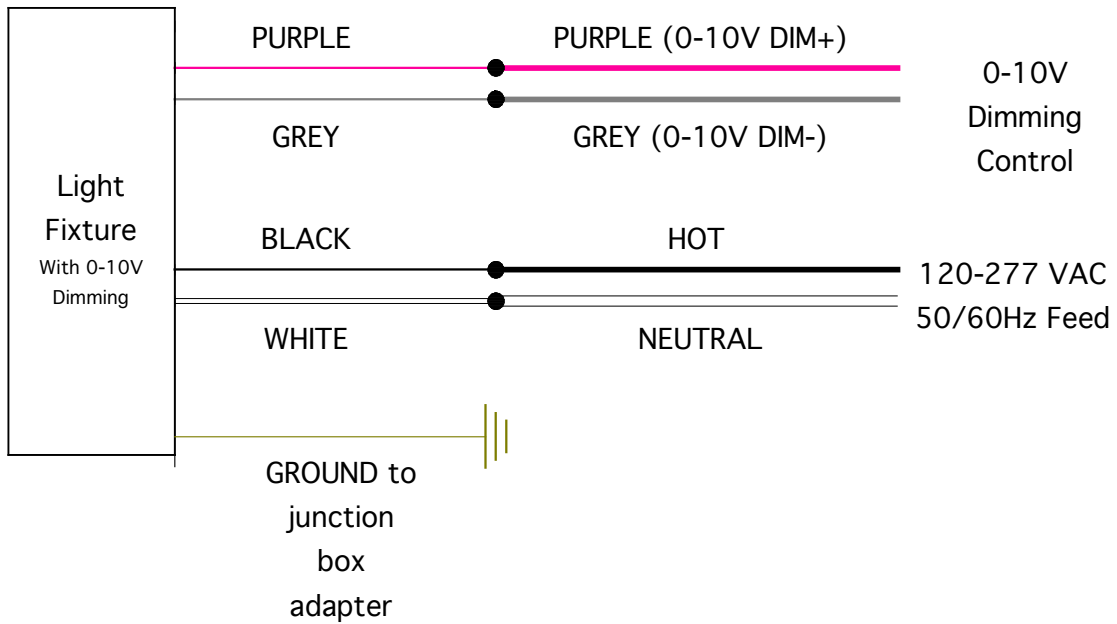

Wiring for EcoSystem™ Digital Control**

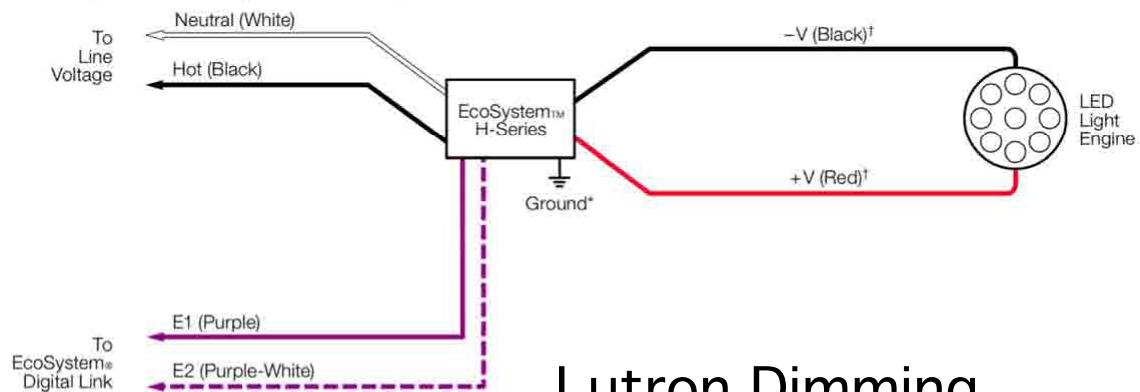

Lutron Dimming

For Lutron 2-Wire Forward-Phase go to:

<http://www.lutron.com/TechnicalDocumentLibrary/041549.pdf>