

ASSEMBLY INSTRUCTIONS

SMITH 17/22 FIELD CUT DROP

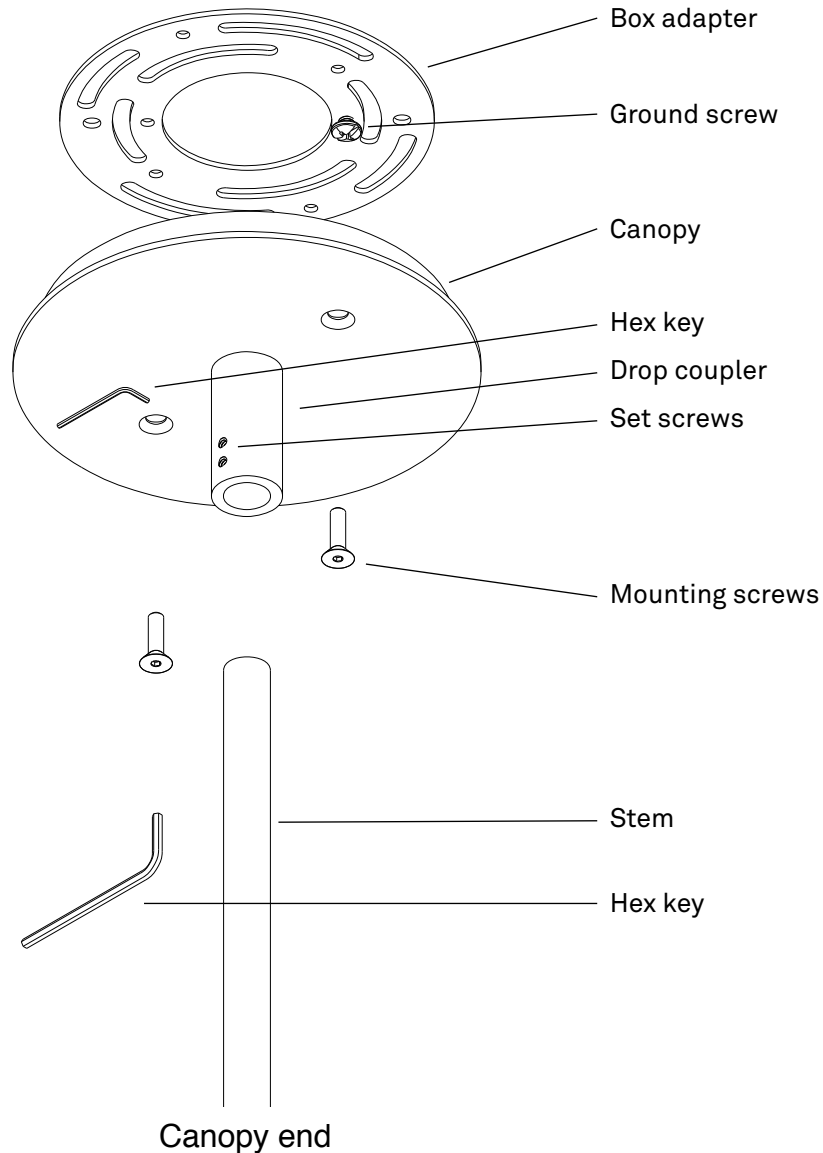

DANGER - RISK OF SHOCK - DISCONNECT POWER BEFORE INSTALLATION

1. Mount the box adapter to the junction box.
2. Determine drop length, trim and de-burr the stem to the appropriate length.
3. Loosen the set screws in both drop couplers so that the stem moves freely into the drop coupler.
4. Feed the fixture leads through the stem, seat the stem inside the drop coupler at the fixture end, and tighten the two set screws to secure the stem.
5. Feed the fixture leads through the drop coupler/canopy assembly. Seat the other end of the stem into the drop coupler on the canopy and tighten the two set screws to secure the stem.
6. Make electrical connections per wiring diagram.
7. Affix canopy to the junction box/box adapter assembly with the two mounting screws provided.

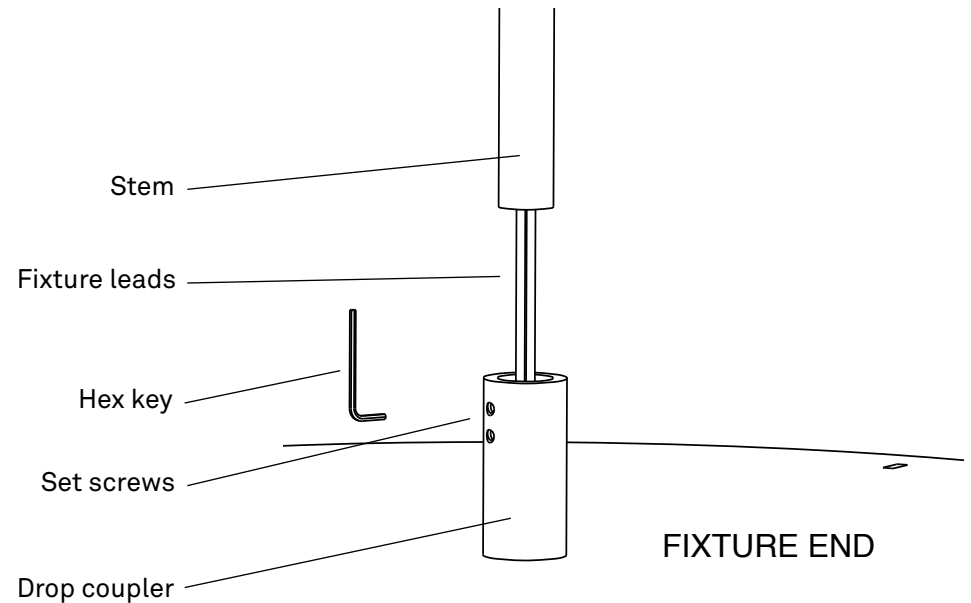

RESOLUTE

RESOLUTE is a registered trademark of
MANIFESTO Corporation, Seattle WA
www.resoluteonline.com info@resoluteusa.com



ASSEMBLY INSTRUCTIONS

SMITH 17/22 - DIFFUSER ASSEMBLY

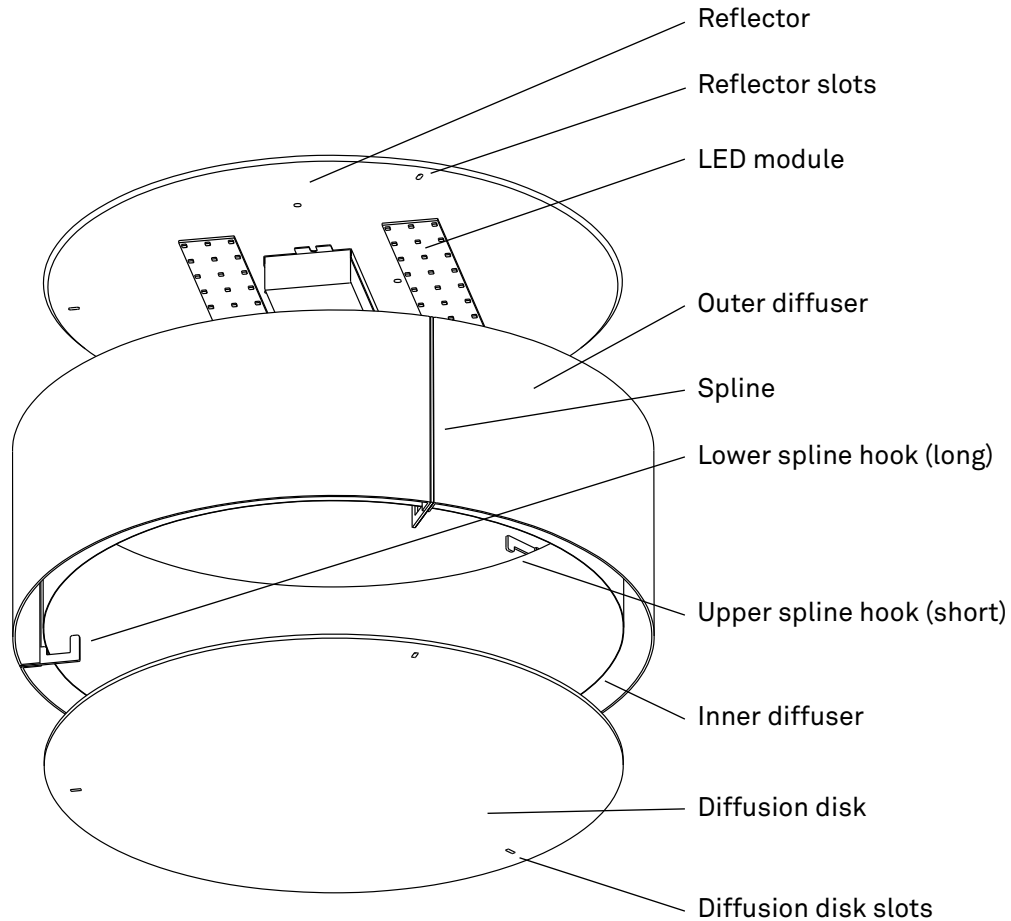

Installing shade assembly

1. Raise assembled shade up slightly above the reflector, making sure that all the upper spline hooks are above the reflector.
2. Insert all three upper spline hooks into slots in the reflector.

Installing bottom diffusion disk

1. Raise the diffusion disk up into the shade at an angle up and over two of the three lower spline hooks.
2. Continue to raise the diffusion disk inside shade so as to clear the third lower spline hook.
3. Lay diffusion disk flat and insert hooks into slots in diffusion disk.

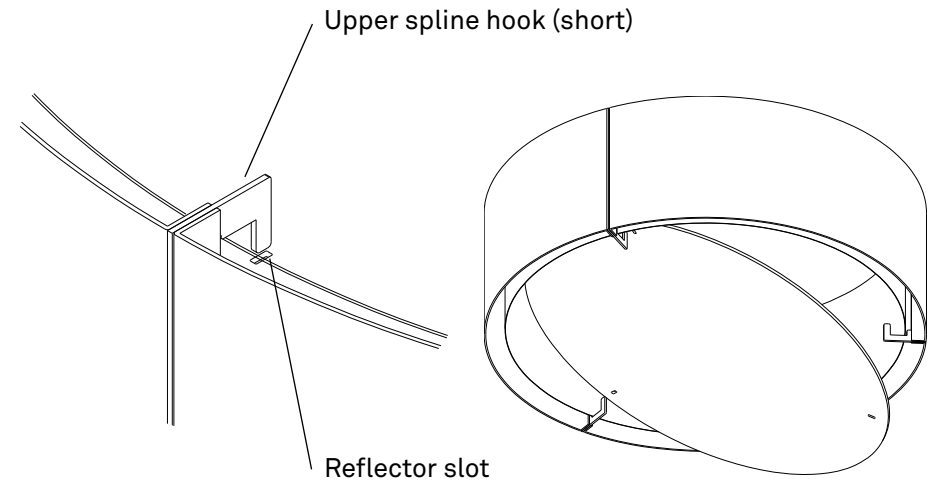

RESOLUTE

RESOLUTE is a registered trademark of
MANIFESTO Corporation, Seattle WA
www.resoluteonline.com info@resoluteusa.com



TRIAC/ELV 10% Dimming

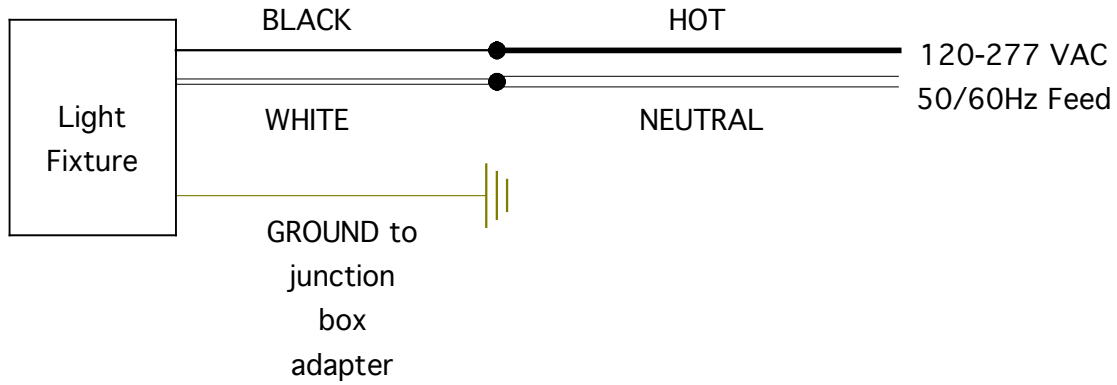

0-10V Dimming

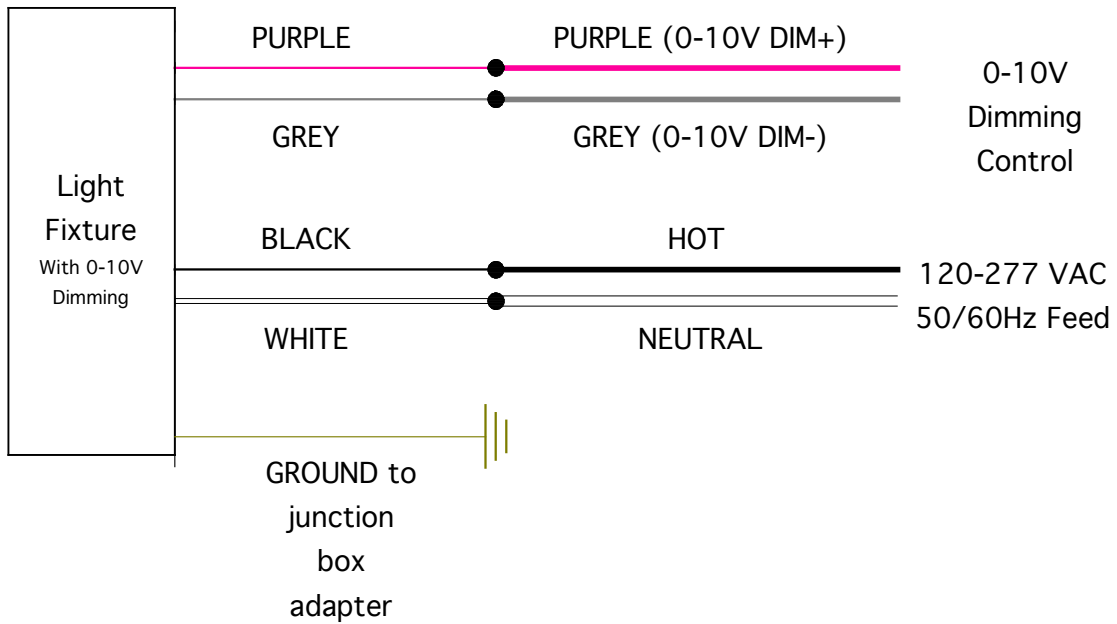

Wiring for EcoSystem™ Digital Control**

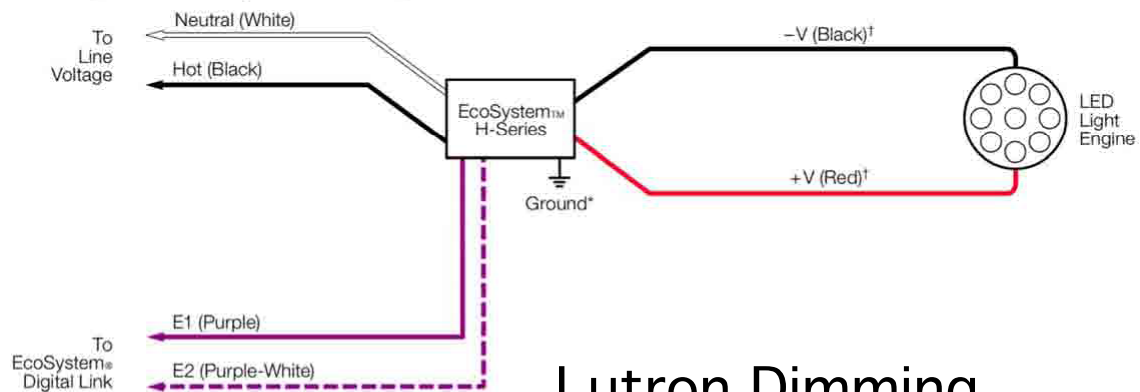

Lutron Dimming

For Lutron 2-Wire Forward-Phase go to:

<http://www.lutron.com/TechnicalDocumentLibrary/041549.pdf>